

∴ **Practical Exam**
∴ **Study Guide**

**CREO SURFACING
PROFESSIONAL CERTIFICATION**



STUDY GUIDE SECTIONS

This study guide will help you prepare for your exam. It describes the skills and prerequisite coursework you need to succeed and provides sample questions. The study guide includes the following sections:

- FAQ
- Sample Questions





FAQ

What is the Creo Surfacing Professional Certification?

The Creo Surfacing Professional Certification validates advanced-level knowledge and application taught in PTC University's LEARN Online curriculum.

Designers and engineers who earn the Creo Surfacing Certification can create complex surface geometry, fix and patch surface models, and create robust curves.

What can I expect when I take the practical exam?

Practical exams consist of a random set of questions based on use cases from PTC University courses. Project specifications and lab files provide the resources you need to correctly answer each question. You should plan to spend at least two hours on your exam, but you can take up to three consecutive hours to complete it. The exam will submit automatically after three hours and the provided virtual learning environment will disconnect.

Do I need to earn the Creo Associate Certification before I try a professional exam?

No, but completing the Creo Associate Certification Exam can prepare you for the Creo Surfacing Professional Certification Exam.

How are certifications used?

This digital credential gives your employers and peers concrete evidence of your capabilities. Once earned, digital credentials can be shared to your social media accounts, embedded in your online resume, or attached to your email signature.





FAQ

Are certifications available for separate purchase?

All certifications are included with the purchase of a LEARN Online Subscription. They can also be purchased a la carte.

How long are certifications valid?

Professional certification credentials are valid for two years. You can retake the exam each year to stay up to date with the latest software knowledge.

What skills should I have before I take the Creo Surfacing Professional Certification Exam?

- Modeling Parts Framework
- Sketcher Geometry
- Dimensioning Schemes
- Selection
- Boundary Blends
- Merge
- Solidify
- Trim
- Offset
- Fill Surface
- Style
- Freestyle

Which classes do you recommend I take before starting the Creo Surfacing Professional Certification Exam?

- Creo: Surface Modeling 1
- Creo: Surface Modeling 2
- Creo: Stitching, Editing, and Solidifying Surfaces
- Creo: Conceptual Design Using Subdivision Modeling
- Creo: Fixing Imported Geometry
- Creo: Advanced Surface Modeling

FAQ

How do I earn a certification?

Getting certified requires serious preparation. Learners who achieve a passing score have hands-on experience with the solution, complete all recommended courses, or do both. For those who complete the recommended courses, the most prepared learners take sufficient notes, participate in class discussions, and finish all course exercises.

The subject material covered by this exam can be found under the Creo Surfacing Training Catalog section.

You have two chances to pass the exam. If you attempt the exam a second time, you may see different questions. The process looks like this:

- Take the recommended courses.
- Register for the exam.
- Review the course materials to prepare.
- Take the exam and earn a passing score of 80%.
- Check your email for a completion notification.
- Accept the digital credential on [Credly](#).



SAMPLE QUESTIONS

The following questions are representative of what you will see in the practical exam. You cannot answer the sample questions because they depend on additional information provided in the virtual lab environment. Sample questions are meant to show an example of what you will encounter and are not intended as a practice exam.

Sample Question 1

Open PRT001.PRT.
Use the provided Surface to create the following solid.
What is the volume?

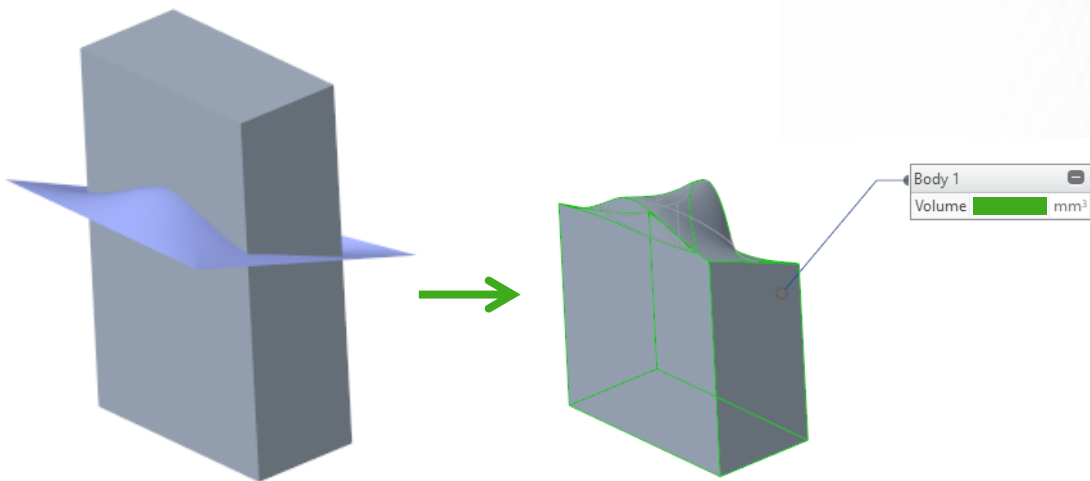

Answers are rounded to the nearest cubic millimeter.

- a. 145
- b. 136
- c. 209
- d. 169

SAMPLE QUESTIONS

Sample Question 2

Open ENGINE.PRT.
Use Surface features to patch and solidify the part.

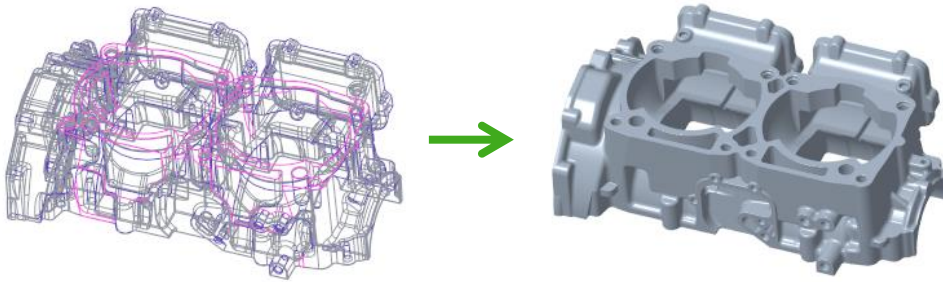

Material: **AL2014**

What is the mass of the part in kilograms?
Values are rounded to the second decimal place.

- a. 2.31
- b. 2.54
- c. 2.93
- d. 1.01